



**Mid Atlantic
LGBTQA Conference**

**Continuing the Conversation:
Religion and Spirituality in LGBTQA Communities**

**November 7 - 8, 2014
Bloomsburg University of Pennsylvania**

Thanks to all of the institutions represented at this year's Conference!

Bloomsburg University
California University of Pennsylvania
Cedar Crest College
Clarion University
East Stroudsburg University
Edinboro University
Equality Pennsylvania
Indiana University of Pennsylvania
Kutztown University
Lock Haven University
Loyola University
Lycoming College
Mansfield University
Marywood University
McDaniel College
Metropolitan Community Churches

Northampton Community College
Penn State Harrisburg
Pennsylvania College of Technology
Shippensburg University
Slippery Rock University
Susquehanna University
The Pennsylvania Student Equality Coalition
The Women's Center, Inc. of Columbia/Montour
Thiel College
University at Buffalo
University of Pittsburgh
University of Richmond
West Chester University
Widener University School of Law
Wilkes University
York College

2014 Mid-Atlantic LGBTQA Conference Planning Committee

M. Safa Saracoglu, Conference Chair
Asa Kelley, Conference Operations Coordinator
Matthew Barcus, Coordinator of LGBTQA Student Services
Debra Chamberlain
Jean Downing
Karli Jayne Miller
Timothy Oleksiak
Shavonne Shorter
Anna Turnage
Craig Young

The Committee would like to thank the following for their valuable contributions to the Conference:

Bloomsburg University
David L. Soltz, President
Robert Wislock, Office of Social Equity
LGBTQA Commission
Gender & Sexuality Alliance
LGBTQA Student Services
Multicultural Affairs
Women's Resource Center
Center for Diversity and Inclusion
Department of Art & Art History
Joan Miller
Ken Dunlap, Media Services Coordinator, Kehr Union Building
Kristi Getty, Scheduling Coordinator, Student Activities
Mary Prout, Facilities Scheduling
Maria Bauman, General Manager, ARAMARK
ARAMARK at Bloomsburg University
Bloomsburg University Police

About our Keynote Speaker—Rev. Irene Monroe

Monroe is a Huffington Post blogger, syndicated religion columnist, and radio commentator. Her columns appear in 23 cities across the country, in the U.K, and Canada. And she writes a weekly column in the Boston home LGBTQ newspaper "Baywindows."

Monroe states that her "columns are an interdisciplinary approach drawing on critical race theory, African American , queer and religious studies. As an religion columnist I try to inform the public of the role religion plays in discrimination against lesbian, gay, bisexual, transgender and queer people. Because homophobia is both a hatred of the 'other' and it's usually acted upon 'in the name of religion,' by reporting religion in the news I aim to highlight how religious intolerance and fundamentalism not only shatters the goal of American democracy, but also aids in perpetuating other forms of oppression such as racism, sexism, classism and anti-Semitism."

Monroe also does a weekly Monday segment called 'All Rev'd Up' on WGBH, a Boston member station of National Public Radio (NPR).

When inviting Monroe to speak, The United Nations International School at the UN wrote, "Rev. Monroe, your active role in the fight against homophobia and your written activism for human rights has truly made an impact on this world, as well as your theories on religion and homosexuality in the U.S."

Monroe is a founder and now member emeritus of the National Black Justice Coalition (NBJC). She is also one of the founders of Equal Partners of Faith, the Religious Coalition for the Freedom to Marry (RCFM), and Christian Lesbians Out (CLOUT).

Monroe was chosen in October 2009 by MSNBC as "10 Black women you should know." Monroe has been profiled in "O, Oprah Magazine." She was also profiled in the Gay Pride Episode of "In the Life TV" where the segment on her was nominated for an educational Emmy.

A native of Brooklyn, NY, Monroe graduated from Wellesley College and Union Theological Seminary at Columbia University and served as a pastor of an African-American church in New Jersey before coming to Harvard Divinity School to do her doctorate. She has received the Harvard University Certificate of Distinction in Teaching several times. She is in the film, "For the Bible Tells me so," an exploration of the intersection between religion and homosexuality in the U.S. and how the religious right has used its interpretation of the Bible to stigmatize the gay community. Her coming out story is profiled in "CRISIS: 40 Stories Revealing the Personal, Social, and Religious Pain and Trauma of Growing up Gay in America" and in "Youth in Crisis." In 1997 Boston Magazine cited her as one of Boston's 50 Most Intriguing Women, and she was profiled twice in the Living Arts and Spiritual Life sections of the Boston Globe for her LGBT activism.



Save the date!

The Eighth Annual Mid-Atlantic LGBTQA Conference

November 6-7, 2015

Bloomsburg University

The Mid-Atlantic LGBTQA Conference Planning Committee would like to announce next year's conference dates of November 6-7, 2015. Please mark your calendars.

Be on the lookout for a Call for Papers which will be circulated in early 2015.

Schedule—Friday, November 7, 2014

7:00 - 10:00 p.m.

The Links at Hemlock Creek, 55 Williamsburg Blvd, Bloomsburg

Black & White Ball

Semiformal dance hosted by the Bloomsburg University Gender and Sexuality Alliance.

Black and white semiformal attire is strongly suggested.

Schedule—Saturday, November 8, 2014

8:00 - 9:00 a.m.

McCormick Center Lobby

Registration & Continental Breakfast

9:00 - 9:15 a.m.

McCormick Center 1303

Welcome and Opening Remarks

Craig Young, BU LGBTQA Commission Chair, Associate Professor of Teaching and Learning, cyoung@bloomu.edu

Jonathan Lincoln, Dean of the College of Science & Technology

9:30 - 10:30 a.m. — Session 1

We are Powerful: Activating LGBTQ Youth-Led Advocacy

Session 1A — McCormick Center 1316

Youth-led organizing is increasingly found on the front lines of advocacy for LGBTQ equality. This session will work through the opportunities and challenges that young activists encounter in the modern LGBTQ justice movement. After reviewing youth organizing models, participants will discuss the development of youth-led efforts within their school communities. The workshop will help student leaders learn practical tools to support youth-led advocacy through providing modern applications which rely on historical, practical, and intellectual frameworks. Those who attend this session will learn how to best activate authentic, sustainable, and effective youth-led advocacy work in movement toward LGBTQ justice.

Turner Stulting, Convener, The Pennsylvania Student Equality Coalition, convener@pennsec.org;

President, Gender and Sexuality Alliance, Bucknell University

Jason Landau Goodman, Executive Director, The Pennsylvania Student Equality Coalition

Taking the Bash Out of the Bible

Session 1B — McCormick Center 2303

More and more, LGBTQ folks are finding it interesting and useful to be more informed about queer sexuality and genderqueer identity in the biblical canon, whether to defend ourselves from homophobic "Christianity" or simply to understand more about our place within tradition and our biblical forebears. This workshop will provide an overview of biblical scholarship and provide a basic understanding of what the bible "really says" about us, including many exemplary characters who are our queer and trans biblical ancestors. Hoffman draws on the work of Horner, Helminiak, Boswell, and others.

Rev. Miller Hoffman, Senior Pastor of Open Door Metropolitan Community Church, Boyds, MD, revmillerjen@gmail.com

10:45 - 11:45 a.m. — Session 2

Creating a Climate of Assessment for Change: You and Your Own LGBTQA Campus Climate Assessment

Session 2A — McCormick Center 1316

Sometimes the thought of assessment can be intimidating, even more so when campus resources are limited. This session is designed for institutions in the beginning process of developing and implementing an LGBTQA Campus Climate Assessment. This session offers a basic overview of how to assess campus climate with minimal resources. Having practical data can be beneficial when working towards increasing resources to better the climate. The emphasis of the session will be upon practical advice and experience. Participants will have the opportunity to discuss individual campus challenges.

Rick W. Schulze, D.Ed., MCHES, Professor, Health Science;

Chairperson, President's Commission on LGBTQ Affairs, Lock Haven University, fschulze@lhup.edu

Gayatri Devi, Ph.D., Associate Professor, English, Member, Assessment Committee, President's Commission on LGBTQ Affairs

Religious Exemptions to Legal Requirements: Understanding the Hobby Lobby Decision

Session 2B — McCormick Center 2303

This session will discuss the Supreme Court's recent holding in the Hobby Lobby case, and the disturbing implications of the court's decision for anti-discrimination laws that protect the LGBT community. The talk will look at the legal ramifications of the decision in a way that will be understandable to those without formal legal training. I will explain the decision and its possible implications.

John Culhane, Professor of Law and Co-Director, Family Health Law & Policy Institute, Widener University School of Law:

Contributing Writer, Slate, johnculhane@comcast.net

Does This Haircut Make Me Look Like A Lesbian? The Body Politics of Hair and Sexuality

Session 2C — McCormick Center 2314

This session looks at the ways in which gender stereotypes can perpetuate discriminatory beliefs about a person's sexuality based on their looks, specifically female hair length. The presentation is based off of several qualitative interviews among women who have experienced both positive and negative treatment based on the length of their hair and what assumptions have been made about their sexuality as a result.

Christiana Paradis, MSW Student, Marywood University, cparadis@m.marywood.edu

Noon - 1:00 p.m.

Lunch — Kehr Union, Multipurpose Room 345

1:15 - 2:15 p.m.

Interactive Workshop — Centennial Hall Gymnasium

Bounce!

This workshop will be about collaboration, communication, interacting, and most importantly having fun with as many people as you can in attendance at the conference. Many times a conference doesn't have time set aside for meeting other people in attendance but this is that opportunity. The activities will be led by the Quest team at Bloomsburg University whose focus is experiential programming with clients of all ages, sizes, and abilities. You will be tasked to discuss and solve problems with rapidly changing teams during this fast-paced activity session.

Brett Simpson, Executive Director, Bloomsburg University Quest

2:30 - 3:30 p.m.

Keynote Address — McCormick Center 1303

Debunking the Myth: The Hierarchies of Oppression

How can we improve campus climates? Many of us experience microaggressions in our work world but we aren't sure how to respond. Perhaps we can begin by thinking about what it means to experience oppression. The hierarchy of oppression is the false belief that one oppression - and it's usually the one a person identifies with - is greater than other oppressions. This talk works toward the goal of community by examining the intersection of race, gender, class, religion and sexuality, and how they impact identity, identification, and community building on college campuses.

Rev. Irene Monroe

3:45 - 4:45 p.m. — Session 3

Where do I start?: Reconciling my Faith and Identity...

Session 3A — McCormick Center 1316

Do you feel your spiritual side gets short shrift because you're LGBTQ? Join me for this interactive workshop where you can learn how to start finding the balance. No matter which religion you are, you can get useful information and practical resources to support your spiritual walk. Participants can share stories, ask questions or simply listen to like minded people all struggling with some of the same issues. Learn how to not settle for mere tolerance; but to be a catalyst for love and acceptance. This is an interactive workshop so you have to feel comfortable with self-evaluation and minimal sharing.

Aneesah Smith, LGBTQA Services Coordinator, West Chester University, asmith4@wcupa.edu

Sexuality & Spirituality: What Could a Campus Conversation Look Like?

Session 3B — McCormick Center 2303

The University of Richmond's Office of the Chaplaincy and Office of Common Ground, the University's diversity initiative, worked together during the 2013-2014 academic year to engage students struggling with questions of faith and sexuality in conversation. They intentionally crafted programs that worked across lines of difference in order to help students critically examine their own beliefs, the beliefs of others, and to derive meaning from the experience. Molly Field, Community Engagement Program Manager and Ted Lewis, Associate Director for LGBTQ Campus Life, share about their selection of "The Laramie Project" as the University's common reading and what partnerships and learning emerged.

Molly Field, Community Engagement Program Manager, Office of the Chaplaincy, University of Richmond, mfield2@richmond.edu

Ted Lewis, Associate Director for LGBTQ Campus Life, Office of Common Ground, University of Richmond, tlewis3@richmond.edu

Modern Masculinity: Male Body Image & Media

Session 3C — McCormick Center 2314

The male body is being increasingly commercialized and commented on. This is a relatively new phenomenon and its effect has been drastic: increased eating disorders, body dysmorphia, depression, etc. Gay and bisexual males are doubly effected as both consumers and targets of this media trend. The focus should be more on healthy, sustainable, and realistic bodies than living up to idealized images.

Matthew Barcus, Coordinator of LGBTQA Student Services, Bloomsburg University of Pennsylvania, mbarcus@bloomu.edu

John Matulevich, Undergraduate Student, Bloomsburg University; Freelance Fitness Writer and Personal Trainer

4:45 - 5:45 p.m.

Town Hall Meeting & Open Forum — McCormick Center 1303

Conference attendees are invited to offer their thoughts and opinions during this interactive conversation. Topics will be participant driven and might range from discussions about issues with which individuals or campuses are coping, questions about current and future programs, or responses to sessions attended at the conference. The floor will be open for discussion and moderated by members of the BU LGBTQA Commission.

Winners of Kindle Fire drawing will be announced, see below for details!

5:45 - 6:00 p.m.

McCormick Center 1303

Closing Remarks

Matthew Barcus, Coordinator of LGBTQA Student Services, Bloomsburg University of Pennsylvania, mbarcus@bloomu.edu

WANTED!!

MEN WHO ARE ATTRACTED TO MEN - 1 in 15 Chance to win a Kindle Fire!

TO COMPLETE RESEARCH SURVEY, just pick up a survey from Dr. Massey, Kris Hawkins, Melanie Seymour, or Sarah Habraken (wearing Rainbow Tie Dye t-shirts). **You must be between the ages of 18 and 40.** After completing the survey (maybe during breaks and lunch), turn in to one of the persons mentioned above. At that time you will be given a slip to fill out for the Kindle Fire drawing. Please turn in the survey and entry before 3:45pm, the drawing will be held at 5pm.

Additional Study Information:

This study involves anonymously answering questions in a survey by marking appropriate choices and adding text as needed. You will be asked to provide information about yourself, your personality, and history/experiences with friends and romantic partners. It is expected to take approximately 30 minutes for you to complete the study. You may skip a question if you do not wish to answer. If at any time during the study you wish to withdraw and not complete the study, you may stop/withdraw at any time.

This research is from a funded grant by the College of Health, Environment, and Science and is being conducted by Drs. Catherine Massey, Jennifer Sanftner McGraw, and Emily Keener in the department of psychology at Slippery Rock University. It is approved through the Slippery Rock University IRB (PRIDE Study 2013-034-70-B).

Thank you for your time,
PRIDE Research Team

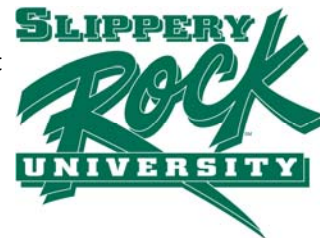

Room locations within Kehr Union

Lower Entrance

Elevator

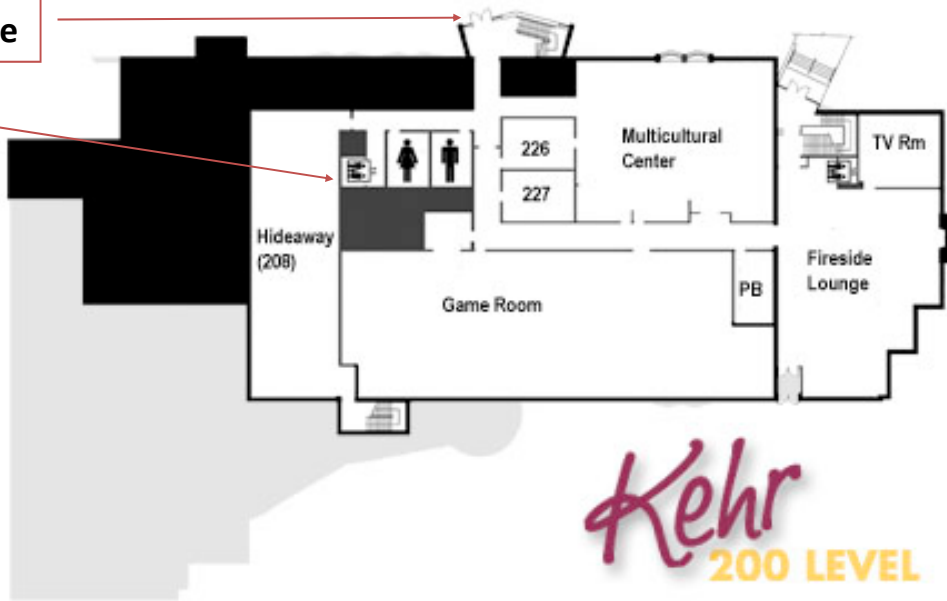

Elevator

Lunch

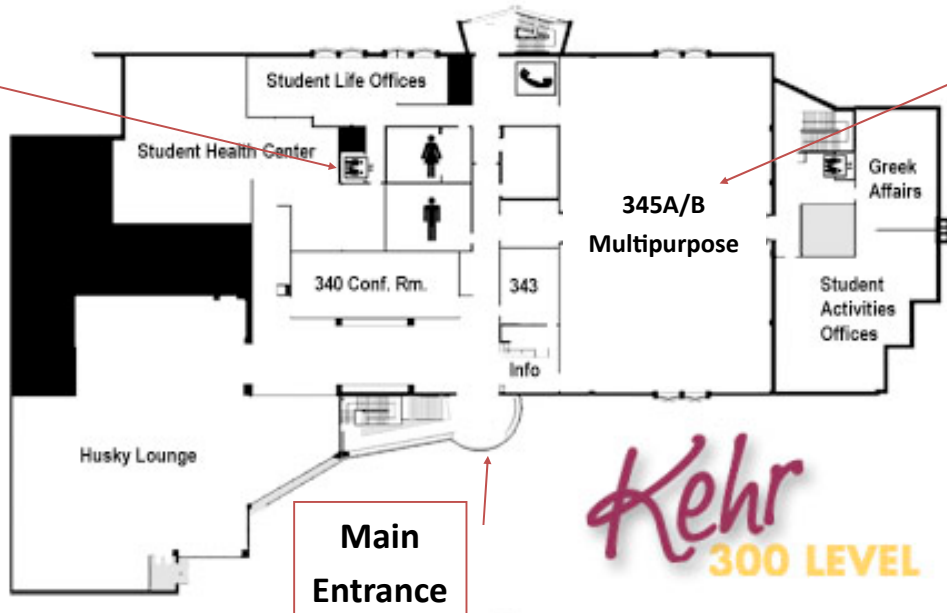

Main Entrance

Elevator

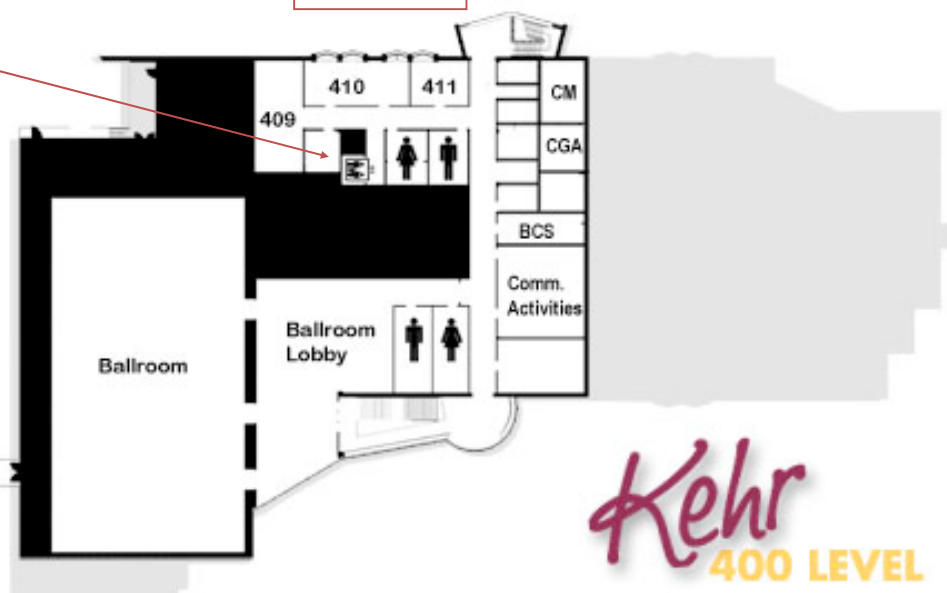

Room locations within McCormick Center

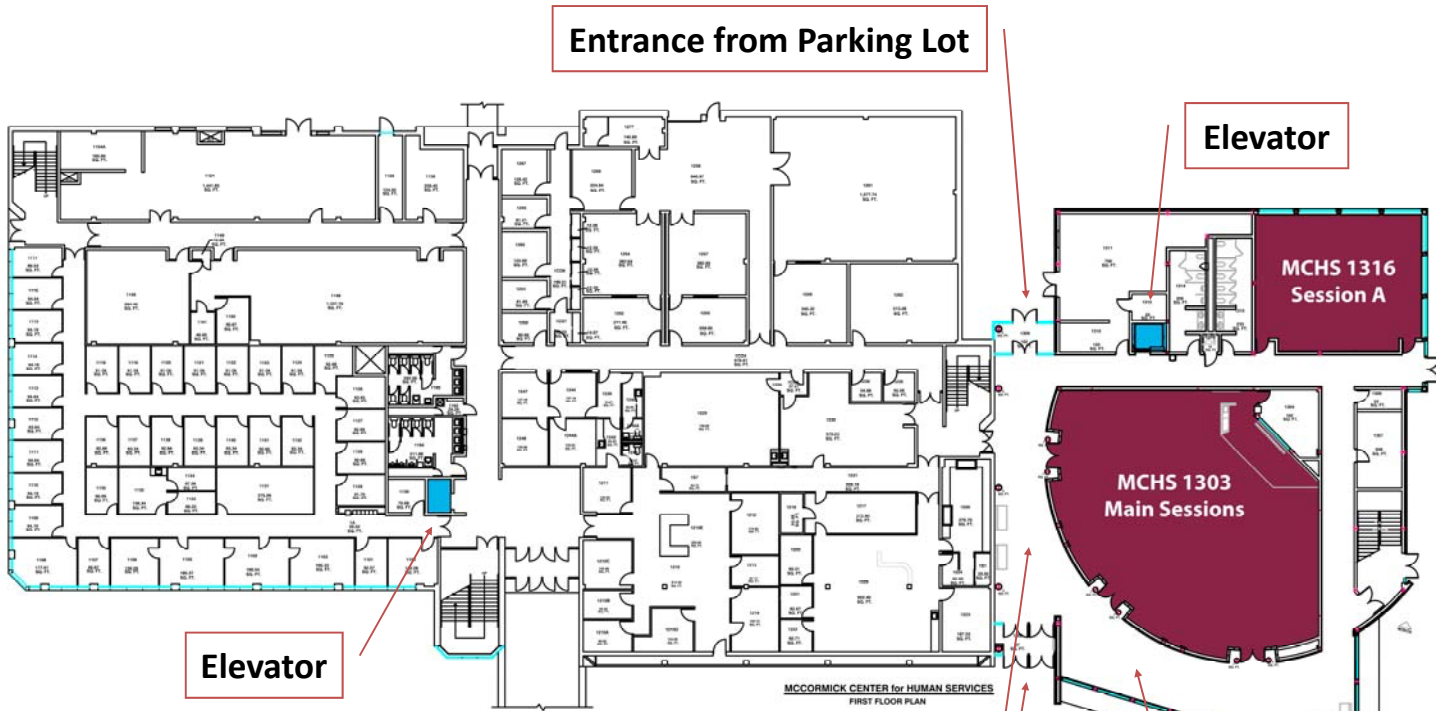

Entrance from Parking Lot

Elevator

MCHS 1316
Session A

MCHS 1303
Main Sessions

Elevator

Registration & Information

Entrance from Quad

Refreshments

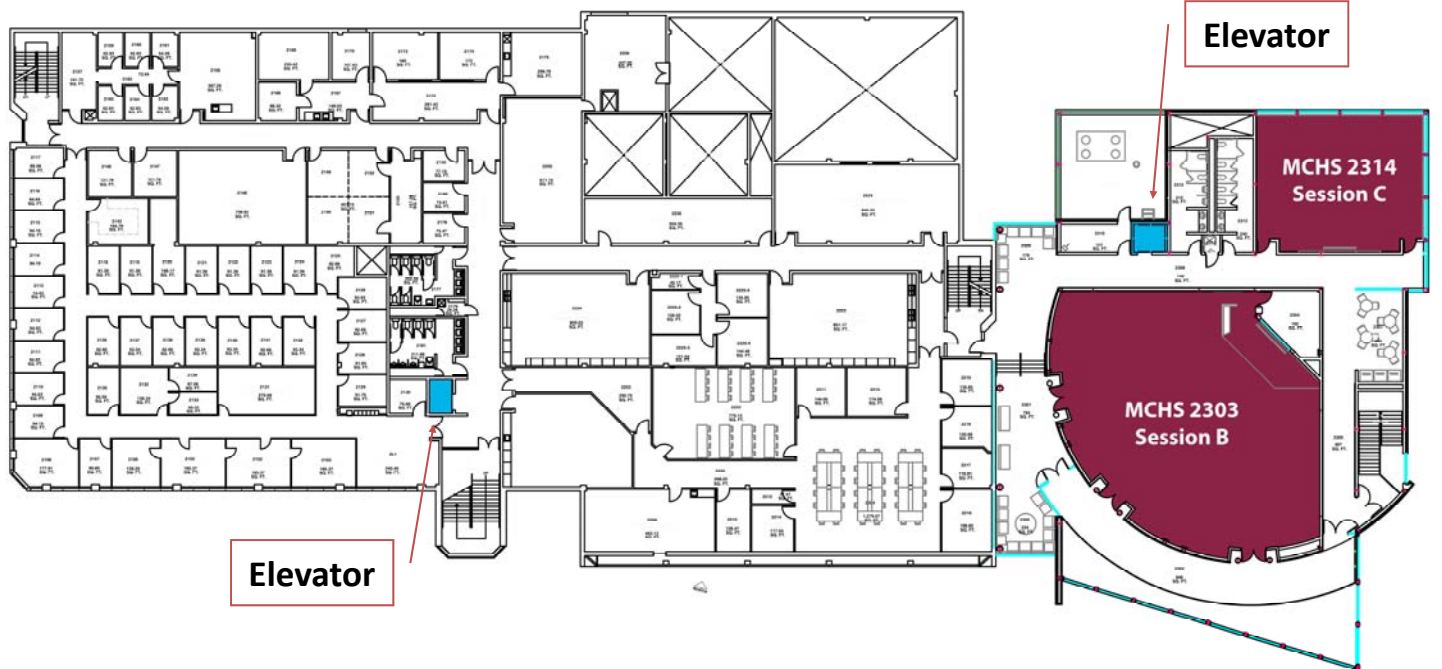

Elevator

MCHS 2314
Session C

MCHS 2303
Session B

Elevator

Internet Access

For your convenience, wireless internet access is available throughout campus. To access the internet from a laptop or other portable device, connect to the bloomu-open network and open your web browser. You will be redirected to the bloomu-guest login page. Click the "Guest Login" button and enter the guest account credentials below. Once you authenticate, you will be able to browse the Internet.

Username: lgbtqa — Password: november

Campus Map

