

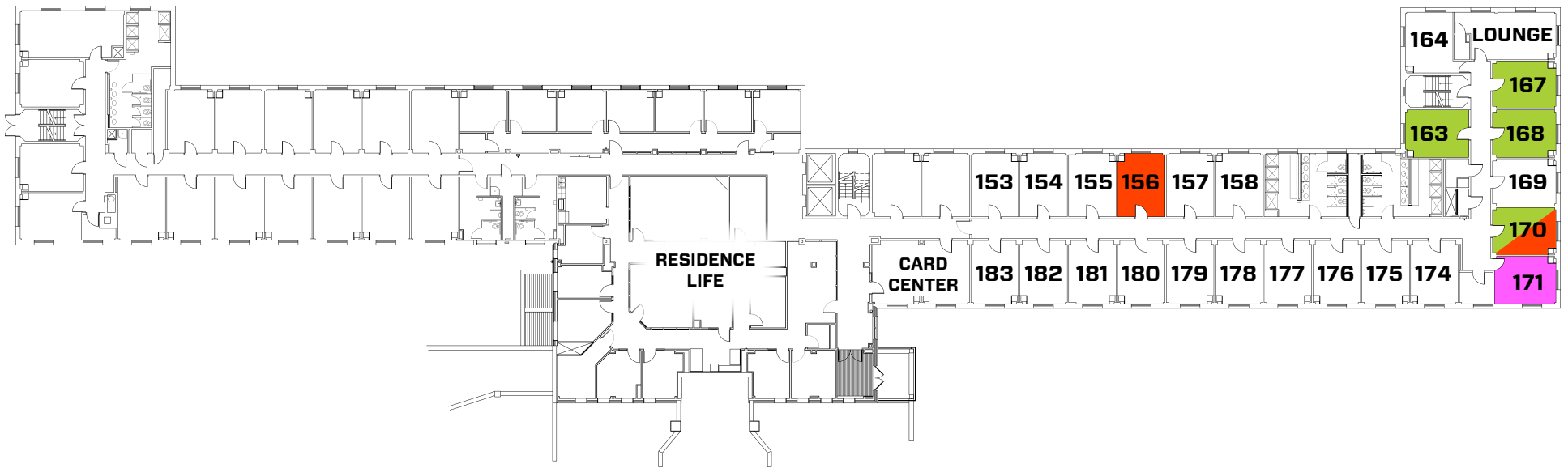



ELWELL HALL FIRST FLOOR



OFFICE OF RESIDENCE LIFE





* COED SIDE-BY-SIDE

 HALL STAFF
 SINGLE

 HEARING IMPAIRED
 TRIAD (3-PERSON ROOM)

 SUITE (WITH BATHROOM)
 QUAD (4-PERSON ROOM)

 -----
 -----



ELWELL HALL SECOND FLOOR

OFFICE OF RESIDENCE LIFE

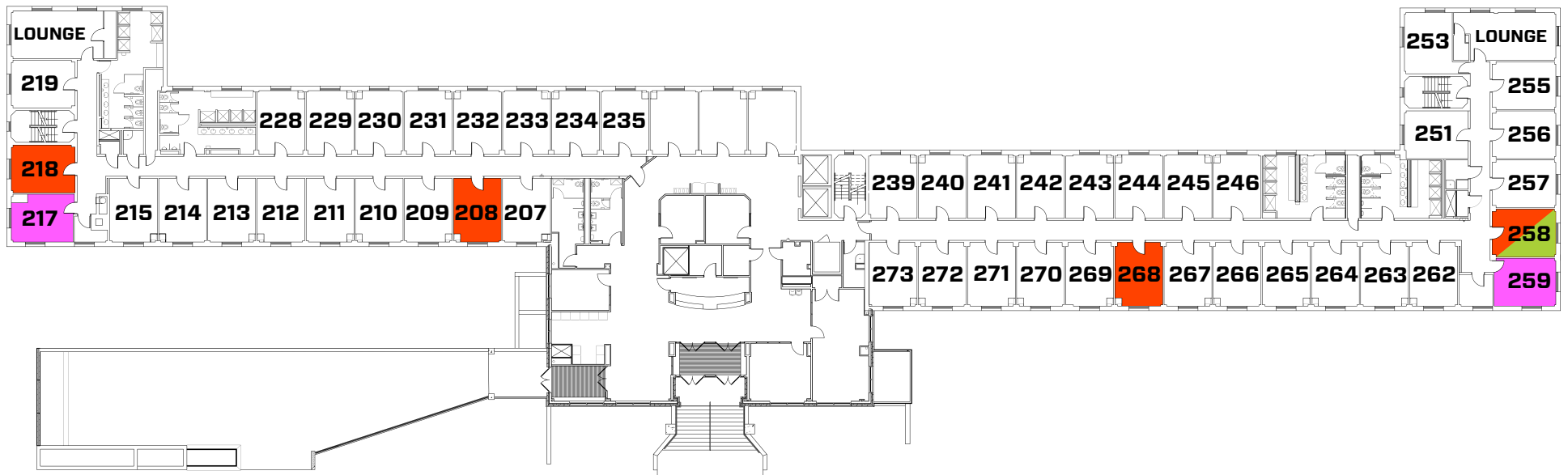

* COED SIDE-BY-SIDE

Orange HALL STAFF
Pink SINGLE

Green HEARING IMPAIRED
Purple TRIAD (3-PERSON ROOM)

Yellow SUITE (WITH BATHROOM)
Blue QUAD (4-PERSON ROOM)

Grey -----
Grey -----



ELWELL HALL THIRD FLOOR

OFFICE OF RESIDENCE LIFE

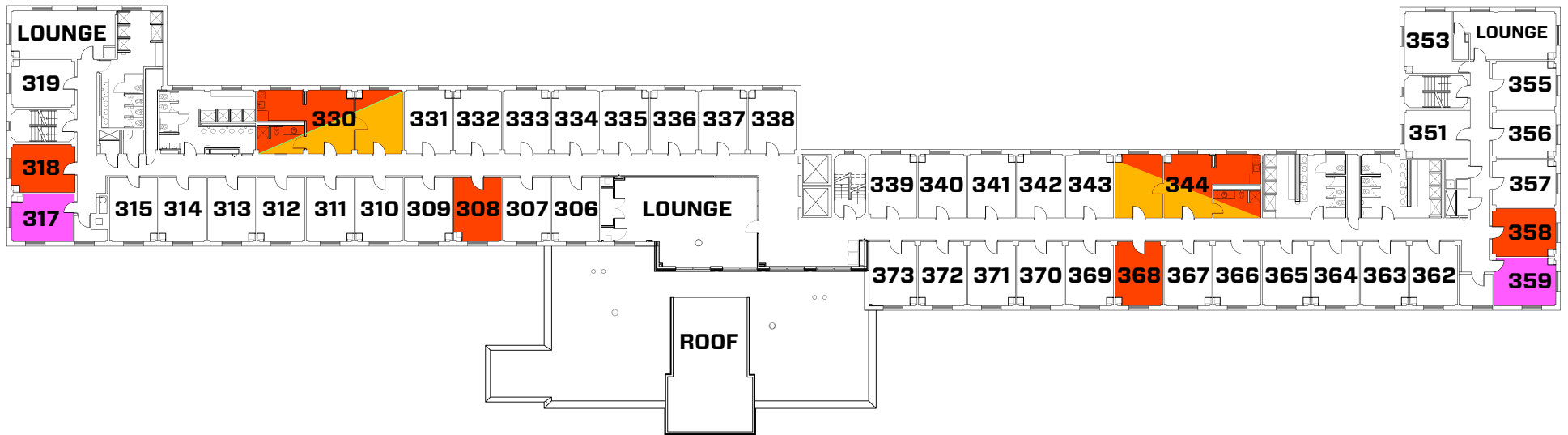

* COED SIDE-BY-SIDE

■ HALL STAFF
■ SINGLE

■ HEARING IMPAIRED
■ TRIAD (3-PERSON ROOM)

■ SUITE (WITH BATHROOM)
■ QUAD (4-PERSON ROOM)

■ -----
■ -----



ELWELL HALL FOURTH FLOOR

OFFICE OF RESIDENCE LIFE

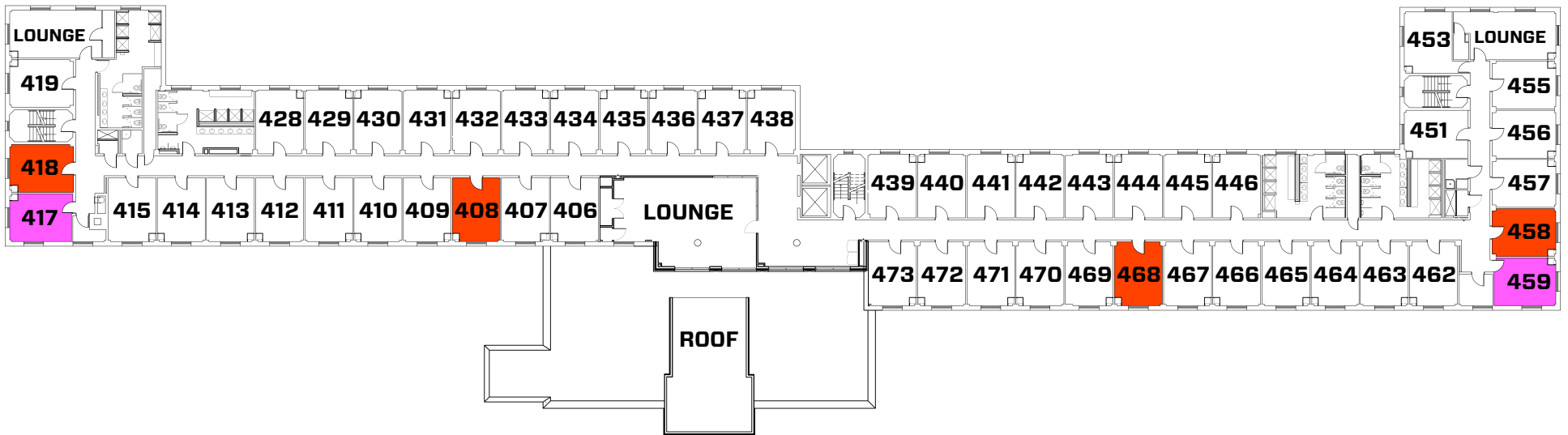

* COED SIDE-BY-SIDE

HALL STAFF
SINGLE

HEARING IMPAIRED
TRIAD (3-PERSON ROOM)

SUITE (WITH BATHROOM)
QUAD (4-PERSON ROOM)



ELWELL HALL FIFTH FLOOR

OFFICE OF RESIDENCE LIFE

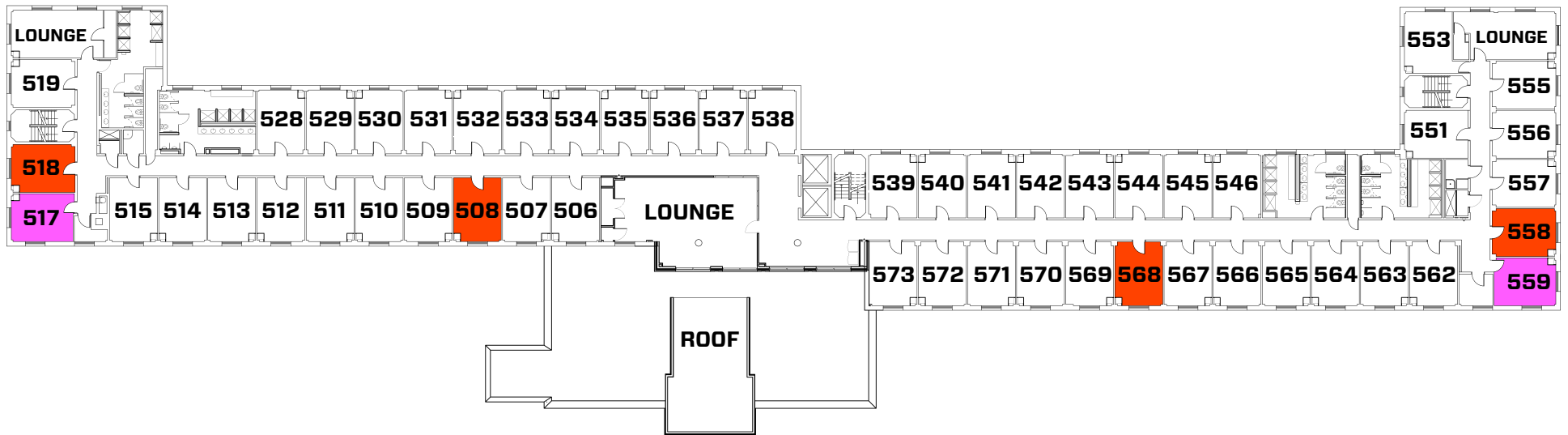

* COED SIDE-BY-SIDE

HALL STAFF
 SINGLE

HEARING IMPAIRED
 TRIAD (3-PERSON ROOM)

SUITE (WITH BATHROOM)
 QUAD (4-PERSON ROOM)



ELWELL HALL SIXTH FLOOR

OFFICE OF RESIDENCE LIFE

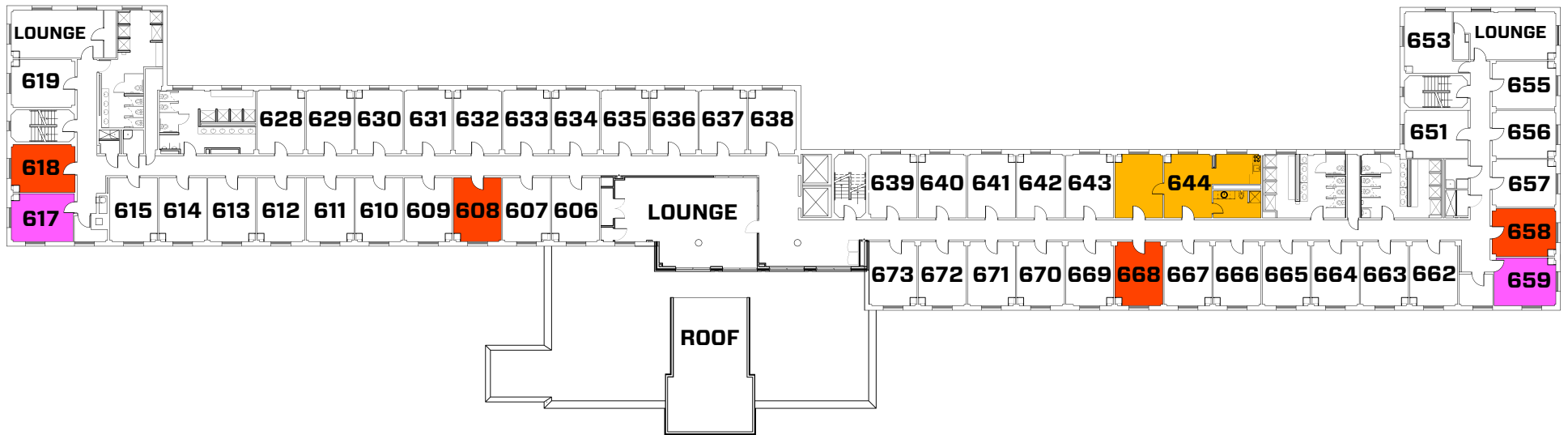

* COED SIDE-BY-SIDE

HALL STAFF
 SINGLE

HEARING IMPAIRED
 TRIAD (3-PERSON ROOM)

SUITE (WITH BATHROOM)
 QUAD (4-PERSON ROOM)



ELWELL HALL SEVENTH FLOOR

OFFICE OF RESIDENCE LIFE

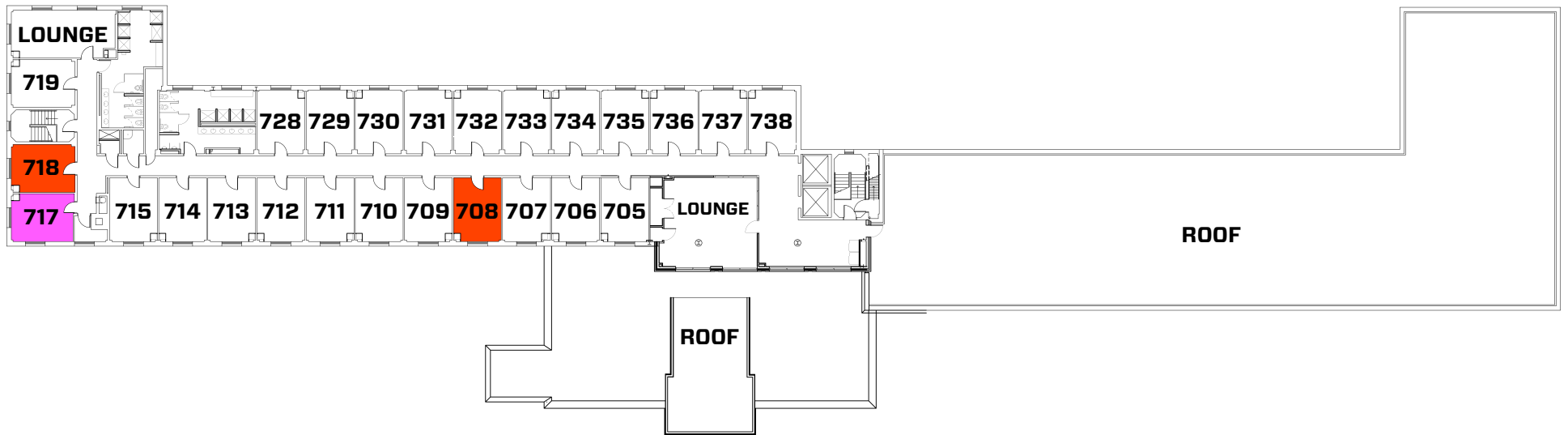

* COED SIDE-BY-SIDE

 HALL STAFF	 HEARING IMPAIRED	 SUITE (WITH BATHROOM)	 -----
 SINGLE	 TRIAD (3-PERSON ROOM)	 QUAD (4-PERSON ROOM)	 -----





ELWELL HALL GROUND FLOOR



OFFICE OF RESIDENCE LIFE





* COED SIDE-BY-SIDE

 HALL STAFF
 SINGLE

 HEARING IMPAIRED
 TRIAD (3-PERSON ROOM)

 SUITE (WITH BATHROOM)
 QUAD (4-PERSON ROOM)

 -----
 -----





ELWELL HALL BASEMENT FLOOR

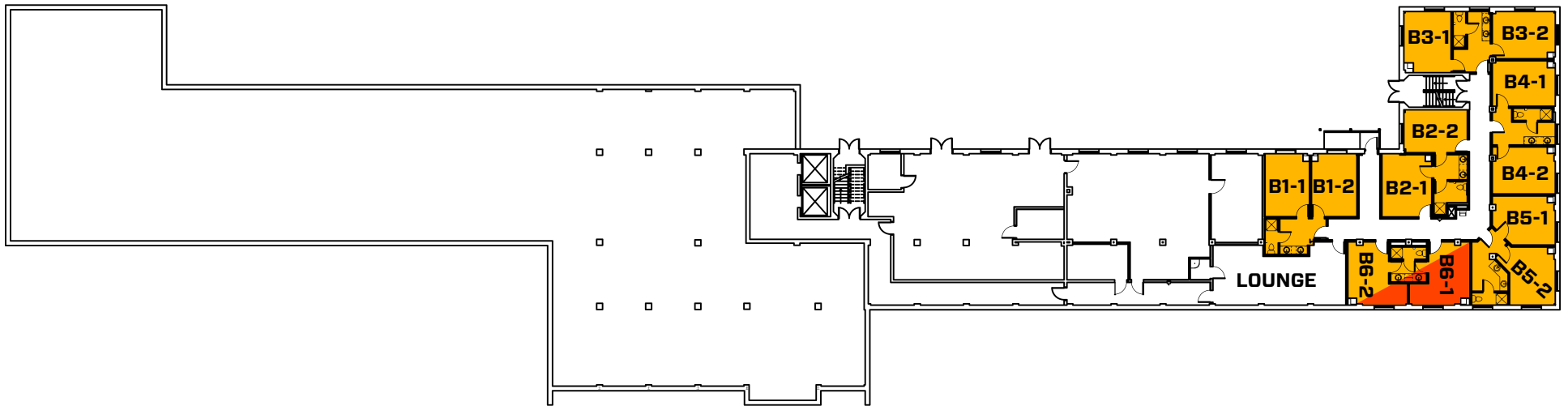

OFFICE OF RESIDENCE LIFE





* COED SIDE-BY-SIDE

-  HALL STAFF
-  SINGLE

-  HEARING IMPAIRED
-  TRIAD (3-PERSON ROOM)

-  SUITE (WITH BATHROOM)
-  QUAD (4-PERSON ROOM)

-  -----
-  -----